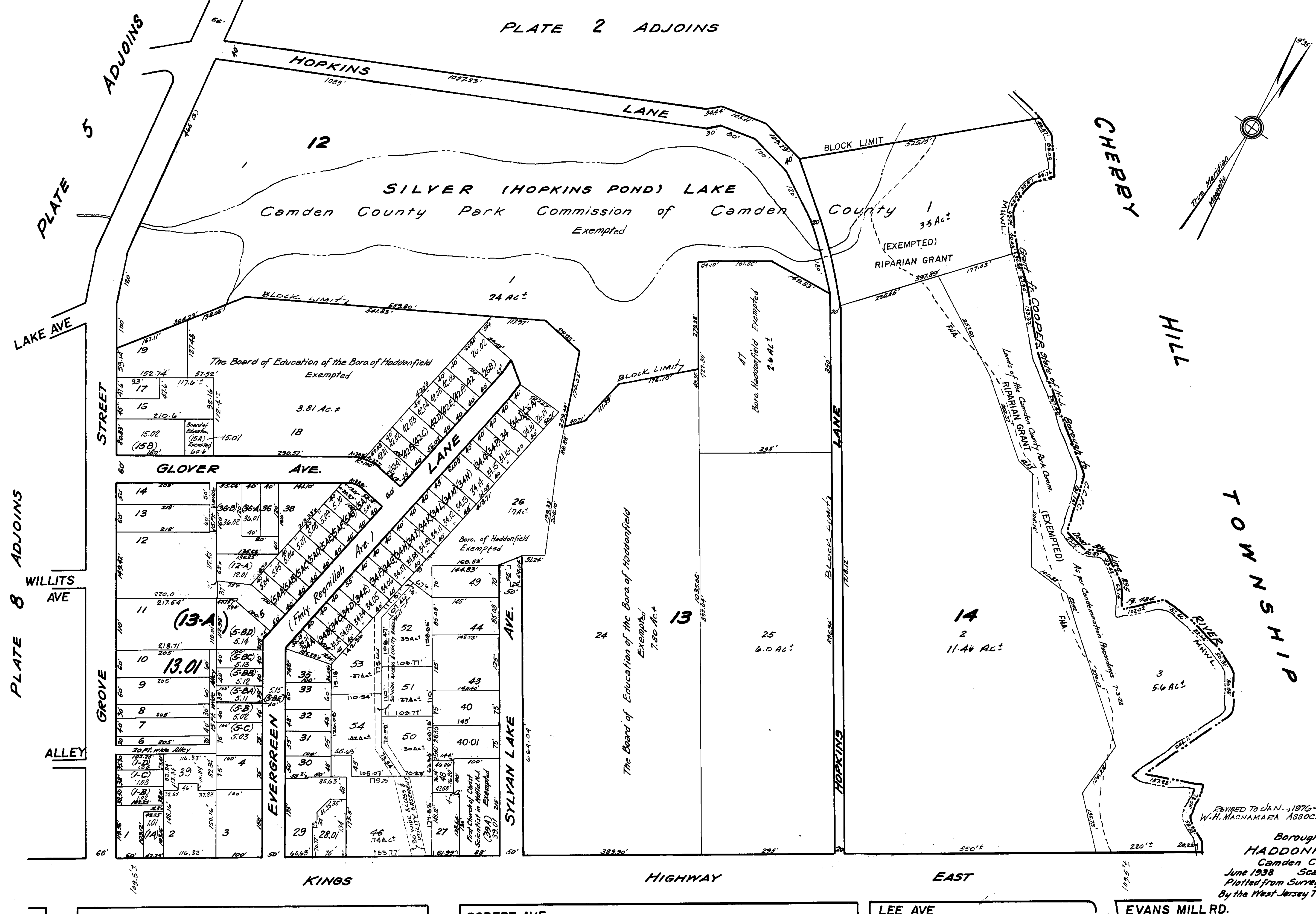

PLATE 2 ADJOINS



REVISED TO JAN., 1976-1979-1982
 W.H. MACNAMARA ASSOCIATES, INC.
 Borough of
HADDONFIELD
 Camden Co., N.J.
 June 1938 Scale 1/4" = 100 ft.
 Plotted from Surveys and Records
 By the West Jersey Title & Guar. Co.

POTTER ST.

ROBERT AVE

PLATE 9 ADJOINS

LEE AVE

EVANS MILL RD.